

EO-VP1000 RUMFORD 1000B – Vermiculite Panels Kit

The Vermiculite Panels Kit allows you to line your RUMFORD 1000B fireplace.

Before you begin the installation, please take note:

- Make sure the bottom of firebox is cleaned before starting the installation.
- Even though all components can be easily installed by one person, you might find the installation easier with a partner handing you one component at the time.
- Three different types of components are used: semi-rigid and rigid insulation panels, and vermiculite panels.
- Vermiculite panels with varying densities are used. Some individual panels, which are not to be meant to be bumped by wood logs, are more fragile than others. Please handle them carefully during the installation.
- Rigid insulation panels are fragile. Please handle them carefully during the installation. Nevertheless, if an insulation panel is cracked you can still install it as long as you make sure to install all its pieces correctly.
- This firebox lining has been designed specifically for the RUMFORD 1000B. No modifications are required to ensure a proper fit.

Please refer to Figure 5 to see an overview of all the vermiculite panels together.

VERMICULITE PANELS INSTALLATION

Please refer to Figure 1 while following the installation procedure below:

1. First, find the throat (1). The insulation panels (2) are already installed in your fireplace.
2. Take the throat (1) and hold the wider part of it with your two hands, flat face towards you. Place yourself down on your knees in front of the fireplace opening. Tilt and slide the throat inside the firebox along the flue divider at the top of firebox. Slowly slide the throat up so you can lay it on the $\frac{5}{8}$ " bend. Let the throat tilt back. It will stay in place by itself.
3. Place the two rear supports (3) against the back insulation panel so that they are centered and 8" apart as shown in Figure 1. They provide a sturdy backing for the lower back vermiculite brick and the middle back vermiculite brick. Use the supports as a straight edge and cut a slit in the back-insulation panel, then insert the rear support so they can rest firmly against the back wall of the firebox.

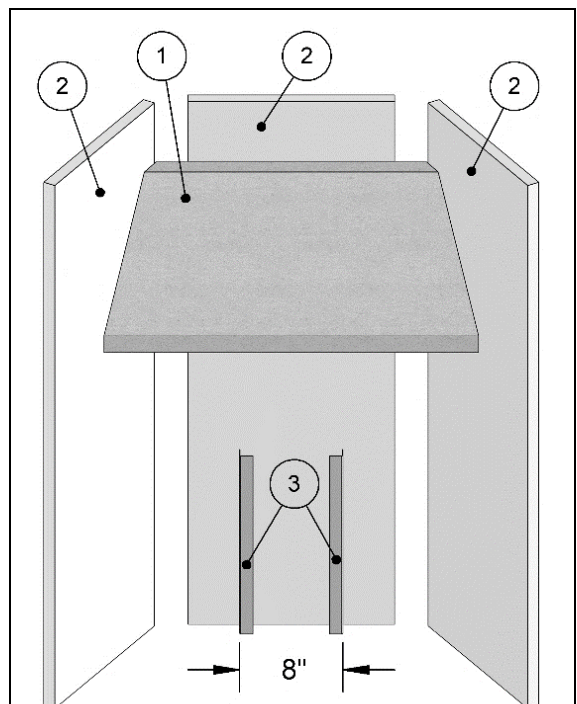

**Figure 1 Insulation Panels and
Fireplace Throat**

Refer to Figure 2 while continuing the installation procedure:

4. Have the seven vermiculite bricks and the two copper wires (four bricks for the sides and three for the back, parts 4 through 10) handy. The rest will be installed at later.

5. Tilt the throat (1) toward the front of the fireplace and slide the upper left side vermiculite brick (4) on the left side of firebox all the way to the top. Let the throat (1) lay down to the upper left side vermiculite brick (4). Hold it with one hand.

6. Install the lower left side vermiculite brick (5), trimmed part up, underneath the upper left side vermiculite brick (4). They will stay in place by themselves.

7. In preparation for its installation, insert the two copper support wires (8b) into the holes at the top of the lower back vermiculite brick (8). They will maintain the alignment between the lower back vermiculite brick and the middle back vermiculite brick. Take the time to look at the corresponding holes in the middle back vermiculite brick (7) into which the copper wires will need to be inserted.

8. Slide the upper back vermiculite brick (6), with the center of the herringbone pattern pointing upward, along the back of firebox, next to the upper left side vermiculite brick (4). Hold it with one hand as high as it will go.

9. While holding the upper back vermiculite brick (6), install the middle back vermiculite brick (7), with the center of the herringbone pattern pointing upward, underneath the upper back vermiculite brick (6). Now move your hand to hold the middle back vermiculite brick (7).

10. While holding the middle back vermiculite brick (7), install the lower back vermiculite brick (8), inserting the copper wires into the corresponding holes in the middle back vermiculite brick (7). The three back vermiculite bricks will stay in place by themselves.

11. Tilt again the throat (1) towards you and slide the upper right-side vermiculite brick (9) on the right side of firebox all the way to the top. Let the throat (1) lay down. Hold the upper right-side vermiculite brick (9) with one hand.

12. Install the lower right-side vermiculite brick (10), trimmed part up, underneath the upper right-side vermiculite brick (9).

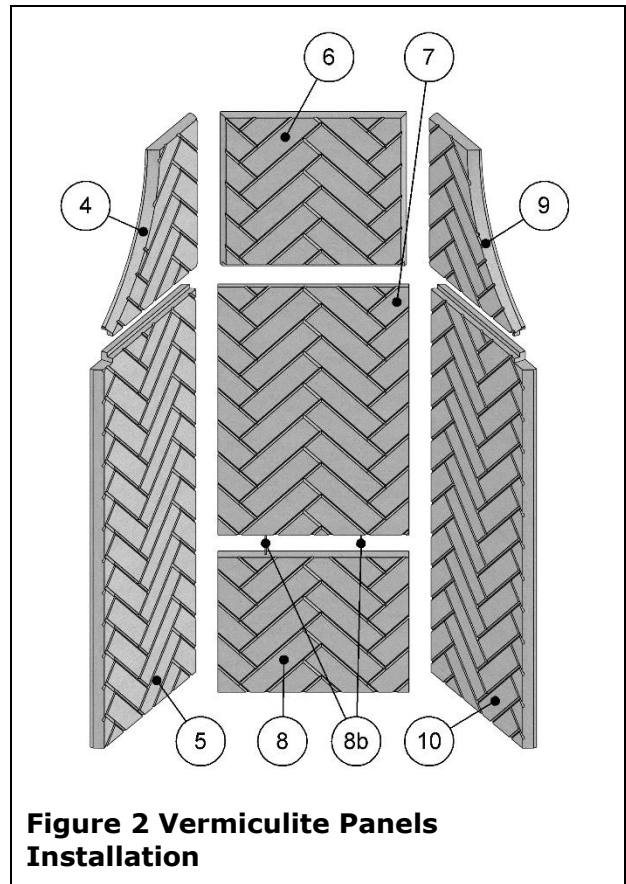

Refer to Figure 3 and Figure 4 to continue with the installation procedure below:

13. Find the two front vermiculite bricks (12 and 13) and place one on your left and one on your right.

14. To install the next vermiculite bricks, make sure the door is fully raised. Hold the top vermiculite brick (11) in the orientation shown on the left side of Figure 3. From inside the fireplace, slide the brick along the front facing inside the firebox, up to the top. Rotate the brick 45° to the back as shown in Figure 3. The notch will fit to the front angle. Hold it with one hand.

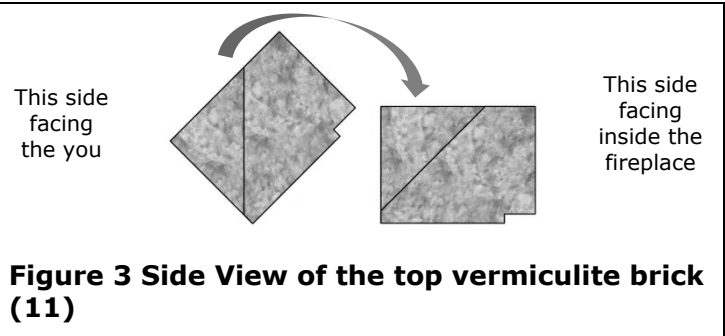

15. While holding the top vermiculite brick (11), install the front left (12) and right (13) vermiculite bricks on each side, the top notch towards the fireplace. The front left and front right bricks should now support the top vermiculite brick.

16. Clean out the bottom of firebox and install both back bottom insulation panels (14) and then both front bottom insulation panels (15). Make sure to have all insulating panels tight together and as close to the front as possible.

17. Install the ash step (16), tight to the front.

18. Install all the bottom vermiculite bricks (17 and 18) as shown in Figure 4.

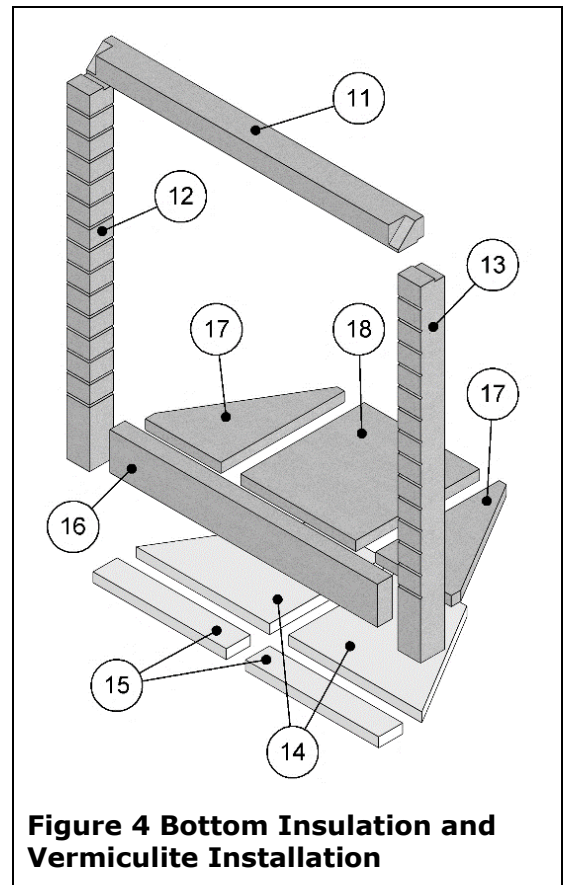

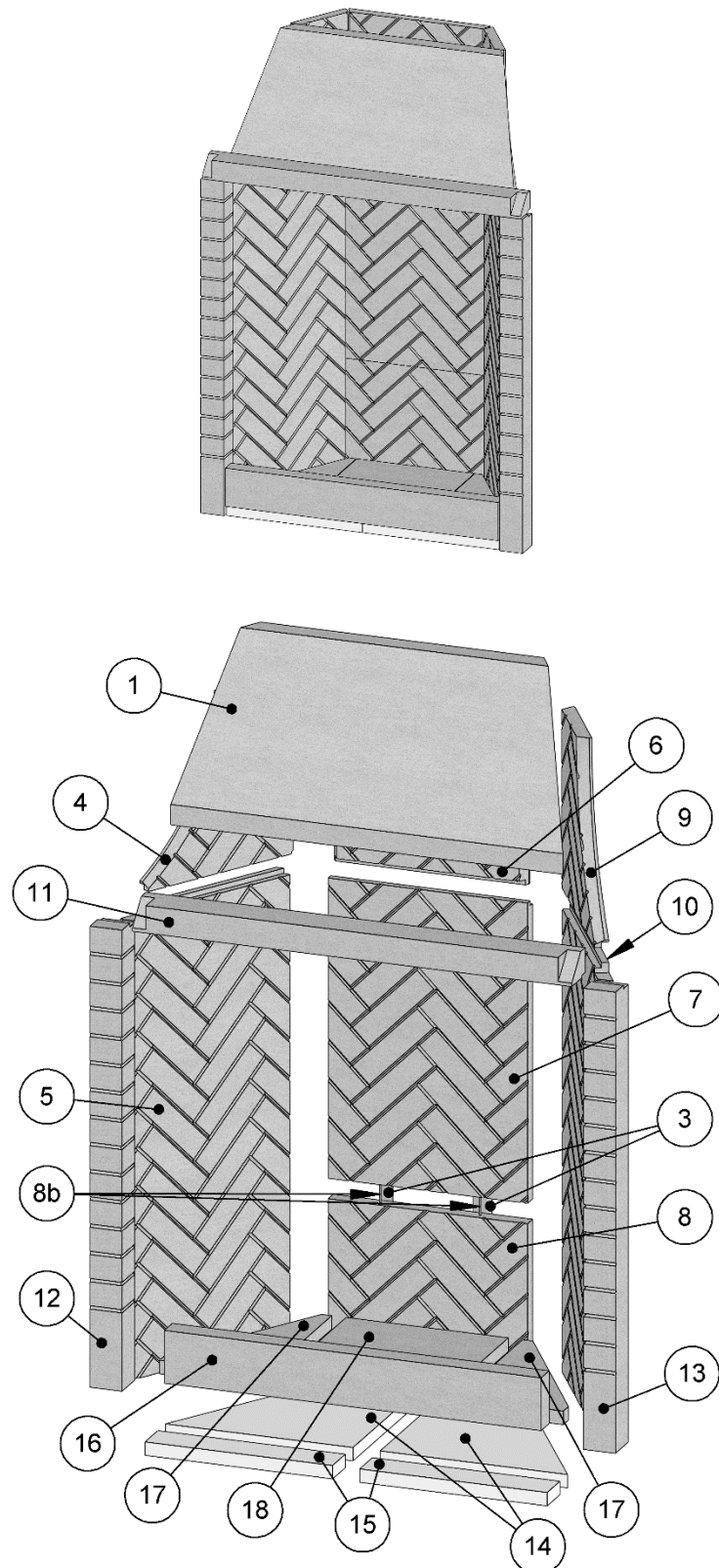

Figure 5 Overall View of Vermiculite Panels